

Community Works Fund (CWF) Grant Application – Third Party

| | | | |
|--|---|--|----------------------------|
| SECTION 1: Ultimate Recipient Information | | | |
| ORGANIZATION The Epicentre Family Co-operative Society | | ORGANIZATION TYPE (SEE DEFINITIONS ON PAGE 4) FP NGO <input checked="" type="checkbox"/> NFP BC-T | |
| SECTION 2: Project Information | | | |
| PROJECT TITLE The Epicentre Family Playground | | ELIGIBLE PROJECT CATEGORY Recreation Infrastructure | |
| DESCRIBE THE PROJECT PURPOSE (MAX. 800 CHARACTERS). The Epicentre Family Co-operative provides recreational programs for children and youth living on Pender Island. In addition to our indoor space, which is well used as a hub for after-school programs and events, the Society is working to create an interesting, challenging and multi-age outdoor playground, one that would allow us to extend our programs and promote fun and active living. The driving force behind revitalizing the outdoor play space is recognizing that our island's resources must grow with our youth in order to give them exciting and positive places to engage and be active. Pender Island is a growing community and offers many rural-living benefits; however it is imperative that we continue to offer dynamic recreation spaces for our children and youth. | | | |
| USING THE ELIGIBLE PROJECT EXAMPLES TABLE ON PAGES 9-10, IDENTIFY AN EXAMPLE PROJECT THAT RELATES MOST CLOSELY TO THE PROPOSED PROJECT (MAX. 200 CHARACTERS) Community centre that offers programming to the community at large. | | | |
| DESCRIBE HOW THE PROPOSED PROJECT IN ITS COMMUNITY CONTEXT RELATES TO THE ELIGIBLE PROJECT EXAMPLE IDENTIFIED ABOVE (MAX. 1000 CHARACTERS) We are aiming to create a fun, creative, engaging and challenging play space that can be enjoyed by island residents and visitors of all ages. The new playground will allow the Epicentre to offer new and enhanced programming for children and youth on the island, and will provide spaces for youth to play and socialize. Our fresh and improved playground will greatly enhance the Auchterlonie Centre which includes the Epicentre Family Co-operative, the Pender Island Library and non-profit Nu-Tu-Yu community thrift store. We estimate over 500 Pender Islanders will visit our playground with children, grandchildren or off island visitors. The Epicentre and Nu-Tu-Yu will enjoy using the playground and having a pleasant place to sit, picnic and watch the children play. | | | |
| DESCRIBE HOW THE PROJECT RELATES TO THE GAS TAX FUNDING OBJECTIVES OF SUPPORTING PRODUCTIVITY AND ECONOMIC GROWTH, A CLEAN ENVIRONMENT, AND STRONG CITIES AND COMMUNITIES. (MAX. 800 CHARACTERS) A vibrant and dynamic play space promotes healthy community values and is a nurturing and supportive facility for families. This attracts families and visitors and thus positively effects local economic growth. This project is regionally significant because Pender Island is a rural area and has few dedicated recreational facilities for youth to play and socialize. The playground's location meets an objective of relieving traffic congestion as it is accessible by school, community bus or Car Stop. It is in a safe area away from main traffic and is fenced. The project is also multi-modal, as it will be used by all ages and levels of ability. It will facilitate regional connection through recreation, play and exploration. | | | |
| SECTION 3: Project Administration and Sustainability Considerations | | | |
| PROJECT LEAD TITLE Epicentre Board Chair | NAME (LAST, FIRST) Christensen, Tina | EMAIL ADDRESS tlchristensen@shaw.ca | TEL. NO. (250) 629-3045 |
| IF THE PROJECT INVOLVES A TANGIBLE CAPITAL ASSET, HOW WILL THE COST OF SUSTAINING IT OVER ITS LIFECYCLE BE FUNDED? (MAX. 800 CHARACTERS) The Epicentre Family Playground will be a long-standing recreation space for the community to enjoy for years to come. Maintaining this space will be undertaken primarily by Epicentre members and community volunteers, and fundraising programs such as concessions and membership fees will be used for maintenance costs. The Epicentre pays into a building maintenance fund that can also be accessed for maintenance, where required. | | | |
| ESTIMATED PROJECT START DATE: 08-Jul-2017 | | ESTIMATED PROJECT ENDDATE: 31-Oct-2018 | |

| | | | |
|--|------------------------------------|---|---------------------------------------|
| SECTION 4: Project Budget | | | |
| PROJECT COSTS AND SOURCES OF FUNDING: | | | |
| Total Project Cost | \$ 24,000.00 | | |
| CWF Request | \$ 12,000.00 | | |
| Borrowing | \$ 0.00 | | |
| Internal Contributions | \$ 12,000.00 | | |
| Other 3 rd Party funds | | | |
| Is the CWF requested replacing other available funding sources for the project? | | <input type="checkbox"/> YES <input checked="" type="checkbox"/> NO | |
| CWF-ELIGIBLE EXPENDITURES: <i>See Eligible Expenditures definition on p. 6</i> | | | |
| Site preparation (machine time to level site, garbage removal) | \$ 1,600.00 | | |
| Capital costs (eg basketball hoop, concrete for pad, playground structures, shed, fence) | \$ 20,400.00 | | |
| Refreshments for community volunteers | \$ 1,000.00 | | |
| Equipment (eg balls, scooters, hockey sticks, hockey net, hula hoops etc) | \$ 1,000.00 | | |
| Sub-Total: Eligible Costs: | | | \$ 24,000.00 |
| CWF-INELIGIBLE EXPENDITURES (<i>See Ineligible Expenditures definition on p. 6</i>) AND OTHER: | | | |
| n/a | | | |
| Sub-Total: Ineligible and other Costs: | | | \$ 0.00 |
| TOTAL COSTS: | | | \$ 24,000.00 |
| SPECIFY HOW THE PROJECT'S CWF-INELIGIBLE AND OTHER EXPENDITURES WILL BE COVERED? (MAX. 100 CHARACTERS) | | | |
| n/a | | | |
| SECTION 5: Project Authorization | | | |
| THIRD PARTY PROJECT LEAD: | | | |
| I hereby certify that this completed application provides a truthful and accurate representation of the proposed project in keeping with the CWF guidelines explained in CWF Grant Application Toolkit – CWF Reference Materials. | | | |
| TITLE <i>Chair of the Board Epicentre</i> | NAME <i>Tina Christensen</i> | SIGNATURE  | DATE: DD/MMM/YY <i>Aug 23 2017</i> |
| CRD FINANCIAL SERVICES: | | | |
| This is certify that: | | | |
| 1. The proposed project complies with the terms and conditions of the CWF Agreement; 2. The project's Electoral Area has sufficient funds in its CWF Account to award the grant requested; 3. The Service involved in the project has the resources to cover the project's CWF-ineligible costs. | | | |
| AUTHORIZED SIGNATORY TITLE Chief Financial Officer | NAME Nelson Chan, MBA, CPA, CMA | SIGNATURE  | DATE: DD/MMM/YY 28-Aug-17 |
| ELECTORAL AREA DIRECTOR APPROVAL: | | | |
| ELECTORAL AREA <input type="checkbox"/> JDF <input type="checkbox"/> SGI <input type="checkbox"/> SSI | DIRECTOR NAME David Howe | SIGNATURE  | DATE: DD/MMM/YY 25-Aug-17 |
| SUBMIT APPLICATION TO THE CRD FINANCE AND TECHNOLOGY DEPT, ATTN: SENIOR MGR, FINANCIAL SERVICES | | | |

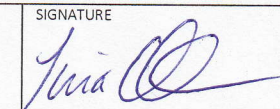
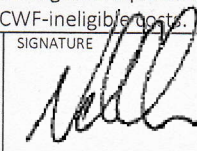
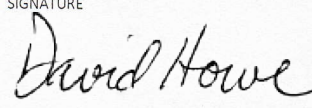
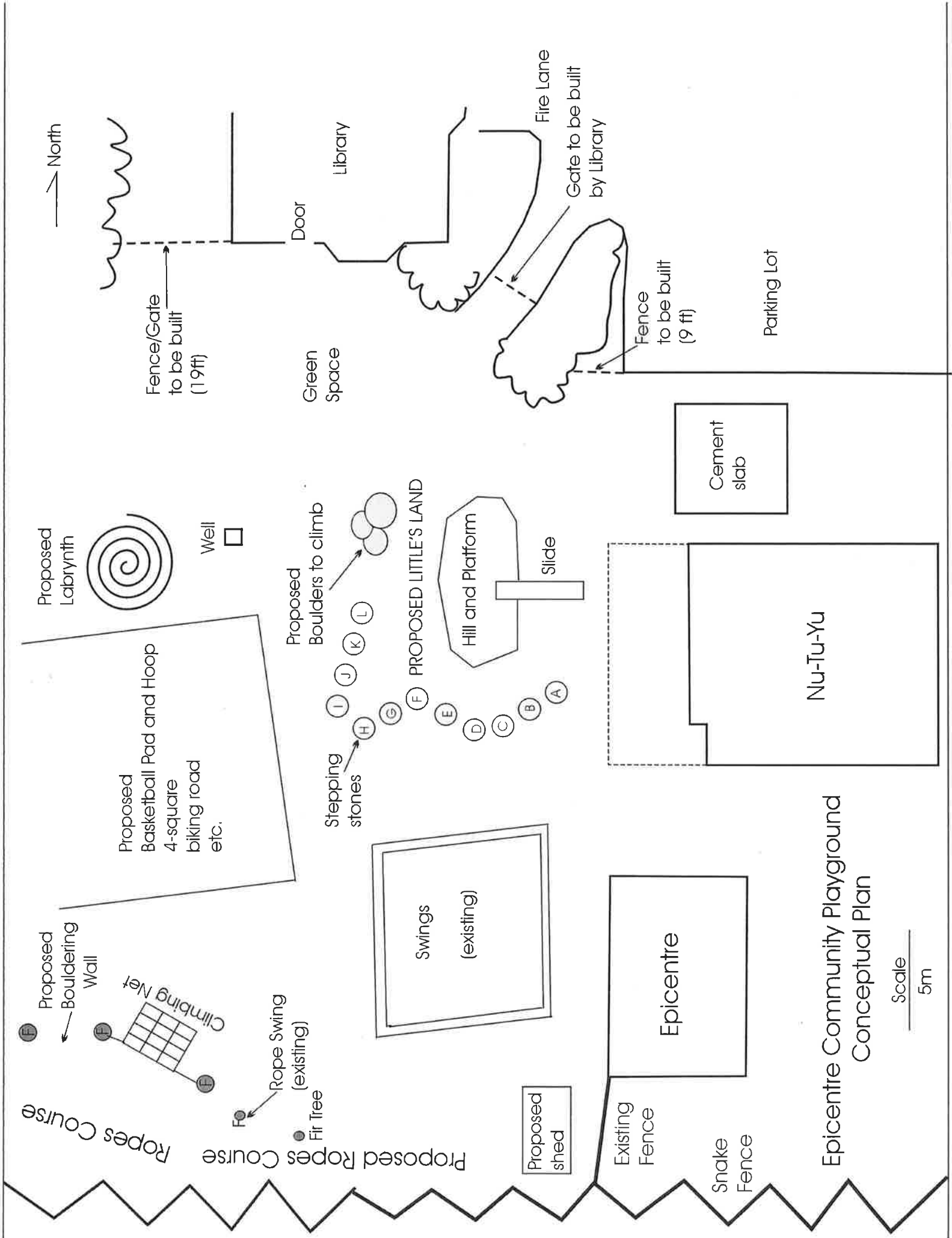

Epicentre Community Playground
Conceptual Plan

Scale
5m

MCPHILLIPS AVENUE

NOTE: GRID LINE "1" IS
OFFSET FROM THE
FRONT SETBACK LINE
BY 25MM TO THE SOUTH

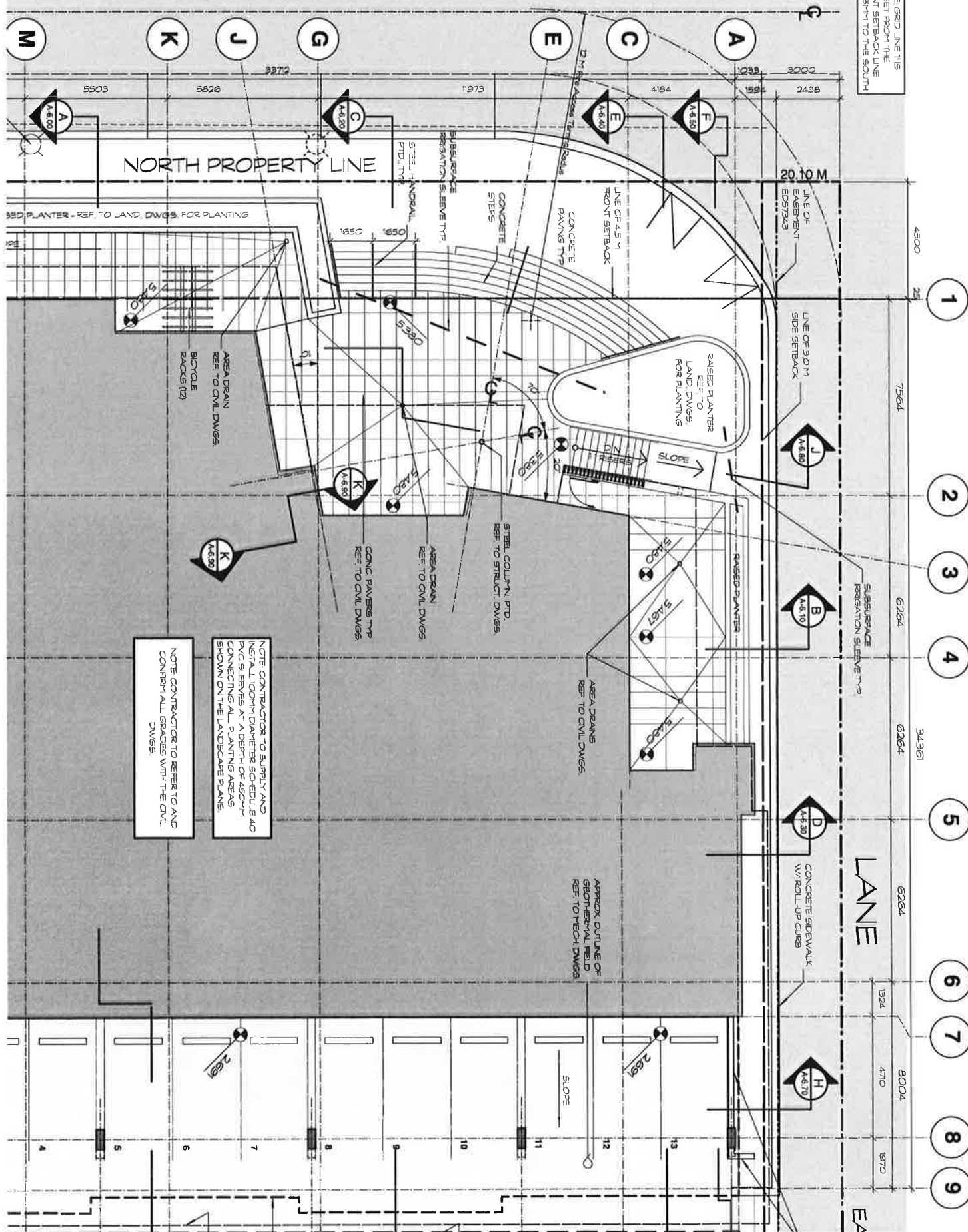



Littles Land

corner
of

B-ball

shelter
tunnel

driftwood
bridge

pen tree

GATE



stepping stones



labyrinth

balanced
beam

*(move to low
ropes course)

climbing
hold



low boulders

include rope
climbs...

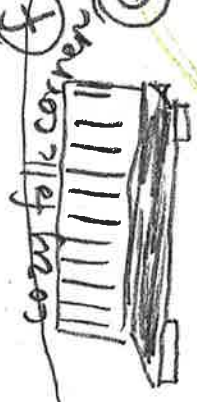
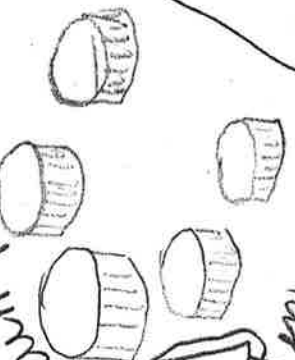

corner folk corner

*(move to low
ropes course)



i
h
g



o
o
o

o
o
o



| Playground Section | Item | Cost | Notes |
|-------------------------------------|---|-----------|---|
| Basketball Pad | Basket ball hoop | 2,500.00 | In ground, regulation sized, adjustable for younger players |
| | Site Preparation (inkind donation) | 1,000.00 | machine time to level ground, remove old play structure |
| | Garbage removal | 600.00 | |
| | Concrete for basketball pad, incl. fill and rebar | 4,600.00 | |
| Ropes Course/ Boulder | Paint for basketball court (protective top coat) | 1,000.00 | |
| | Rope course | 800.00 | Lumber, bolts, rope and cement - tires free. |
| | Climbing wall and structure | 1,000.00 | Bouldering wall one side, net other. |
| | Climbing Net | 500.00 | 4ft wide by 7 ft high, estimate from Grey River Netting. |
| Littles Land | Bench | 500.00 | Colin Hamilton - discounted. |
| | Slide | 0.00 | Already have. |
| | Alphabet stepping stones | 100.00 | Cement, rocks for alphabet free from beach. |
| | Stumps / fill and soil for small hill for slide | 0.00 | Found locally for free/ from landscaping |
| | Climbing hand and foot holds for large boulder | 100.00 | Boulder free. |
| | Small covered structure for littles land | 3,000.00 | |
| | Gazebo or covered seating area | 3,000.00 | |
| | Flat stones/bricks for labyrinth | 100.00 | |
| Fence/ Gate/ Shed/ Equipment | Gate | 1,000.00 | Donated by Library. |
| | New fence | 1,000.00 | |
| | Refreshments for volunteers | 1,000.00 | for all the many hardworking volunteers |
| | Equipment | 1,000.00 | basketballs, hula hoops, hockey net, hockey sticks etc |
| | Shed | 1,200.00 | Home Hardware - discounted. |
| Total | | 24,000.00 | |

Revenue raised to August 20, 2017

| | | |
|------------------------------|---|----------|
| Grant Revenue | Nu-tu-yu | 3,000.00 |
| Donated Time | Braeden Bigham- estimated cost of machine | 1,000.00 |
| Epicentre Fundraising | Lemonade stands | 1,100.00 |
| | Bioblitz Lunches | 600.00 |
| | Concession- Stoney Pocket | 460.00 |
| | Calandar sales | 350.00 |
| Community Donations | Go Fund Me campaign | 1,489.00 |

| | |
|------------------------------|-----------------------------|
| Total to Aug 20, 2017 | |
| Art show donation | 100.00 |
| Island Savings donation | 250.00 |
| | 8,349.00 |
| PROJECT PHASES | |
| PHASE 1 | 9,700.00 IN PROGRESS |
| PHASE 2 | 5,200.00 |
| PHASE 3 | 6,800.00 |
| PHASE 4 | 2,300.00 |

LITTLES LAND

Dreams...

- ☐ Simple, low landscape with slide
- ☐ A little hill created to scramble up & down
- ☐ Low “rock” hand holds to climb up easy incline
- ☐ Cozy Tunnel or small hut
- ☐ Little bridge
- ☐ Large smooth letter stepping stones
- ☐ Low wood stumps
- ☐ Long log to walk along
- ☐ Small Covered area
- ☐ Bench for mamas and papas
- ☐ Small swirl Labyrinth to walk
- ☐ Low boulder to climb









LOW ROPES COURSE AT THE EPICENTRE – SOME INSPIRED IDEAS



Things to do with rope...



Simple Rope bridges



Double Rope crossing between trees



Things to do with logs – a.k.a driftwood or fallen trees.

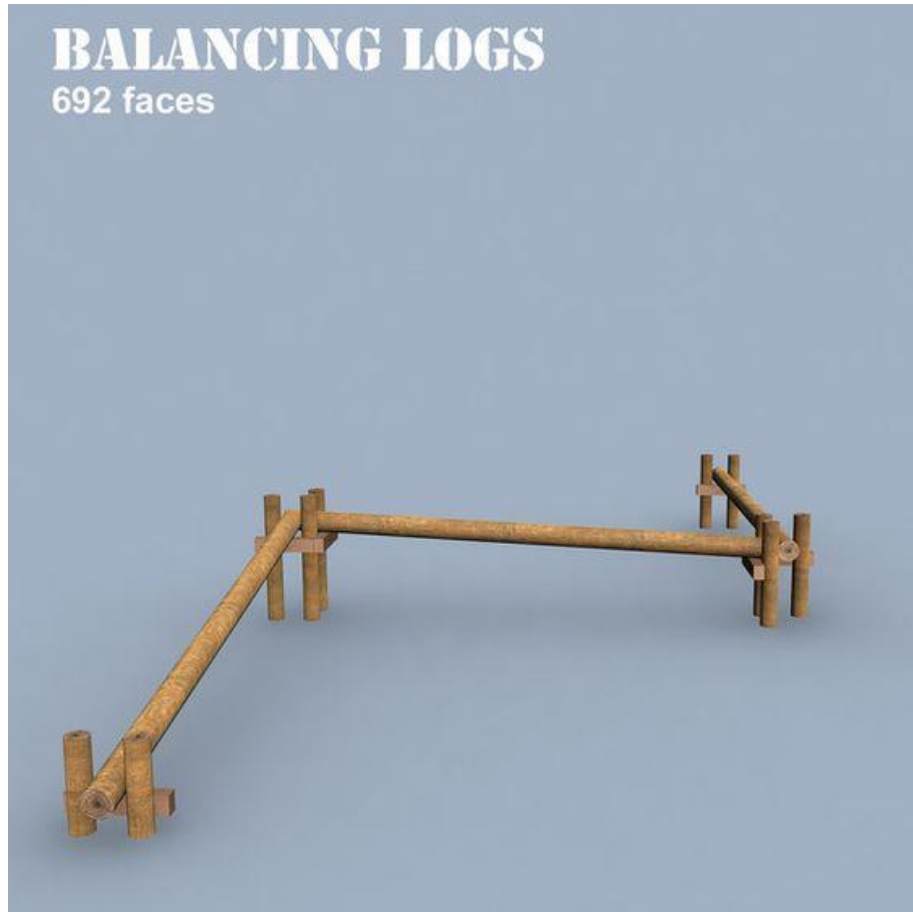

fun with tires on ropes in the trees



Stumps and platforms



Ladders

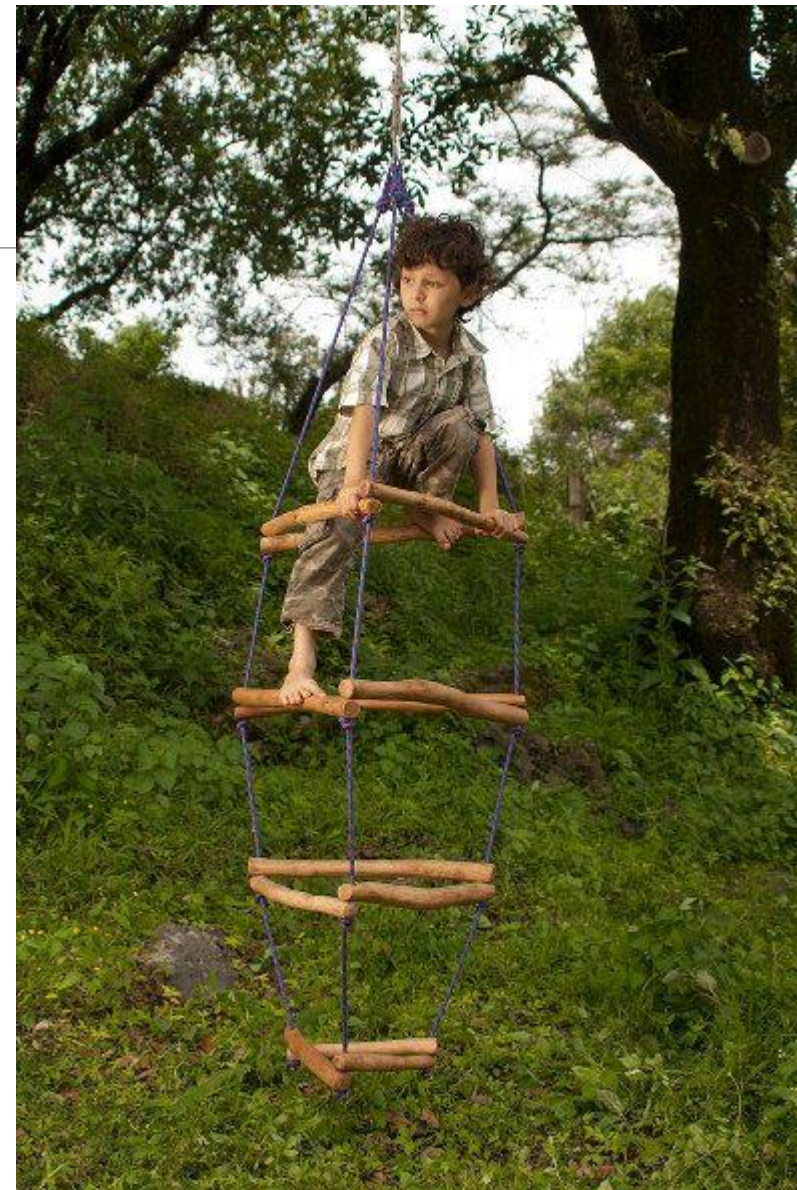

Walkways and bridges



The possibilities are endless really...
